

Installation guide

**Solenoid valve**

Type EV227B

032R9277

032R9277

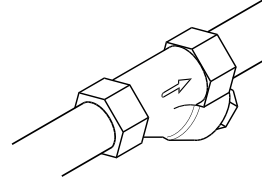
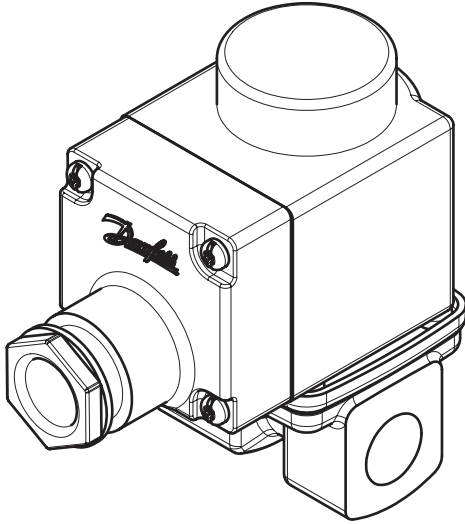

≥ 297 Microns

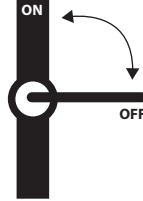

1

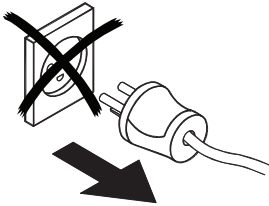

2

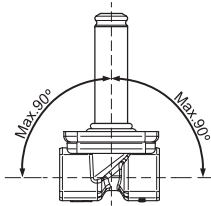

3

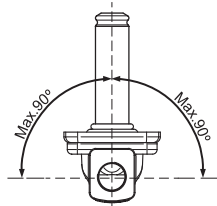

4

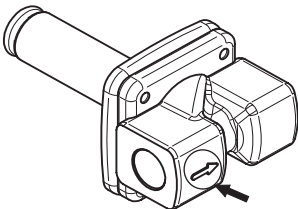

5

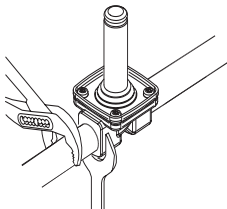

6

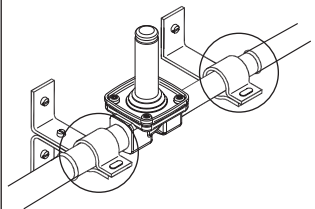

7

8

9

10

11

12

13

DN	Max. Working Pressure (MWP)	Max. Test pressure (PT)
	[bar]	[bar]
10 - 22	10	16
EN 60730-2-8		

Visit [www.products.danfoss.com](http://www.products.danfoss.com) for further technical data.  
 Para más información, visite [www.products.danfoss.es](http://www.products.danfoss.es)  
 Rendez-vous sur le site [www.products.danfoss.fr](http://www.products.danfoss.fr) pour plus de données techniques.